



INSTALLATION INSTRUCTION



AFTERCARE

Whilst modern plating techniques are used in the manufacture of this product , the surface will be affected if cleaned incorrectly.

Surfaces should be maintained using a clean damp cloth ,no abrasive agents or materials should be used or come into contact with the surface finish , or this will invalidate your guarantee

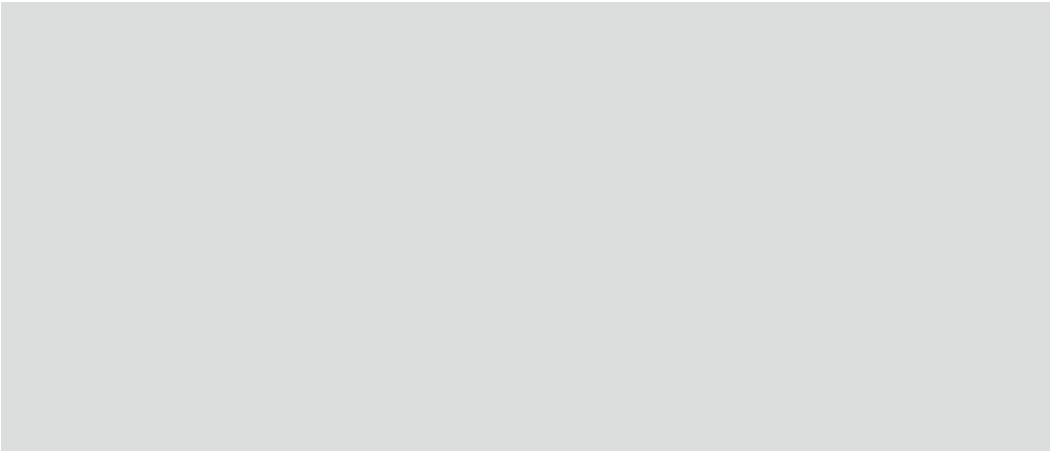

TECHNICAL SPECIFICATION

Item NO.	RB.TRC.0FA600.CB.PI
Power	DC:6V(4AA alkaline battery)
	AC:220V50/60HZ
Power Consumption	DC:<0.2mW □ AC:<2W
Sensor time	Opening time<1S,Closing time<1.5S.
Water Pressure	0.05MPa-0.6MPa
Sensing Distance	Sensor range:factory setting:15cm, Tolerance: 0%.
	Range setting: 5-25cm (The sensor range can be adjusted through the magnet).
Temperature	1°C-55°C
Water Temperature	1°C-45°C
Dia.Of Inlet Pipe	G1/2"

INSTALLATION STEP

Power connect

- ☒ AC: Connect the transformer

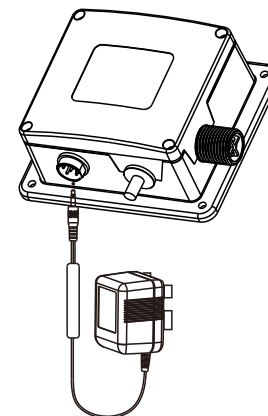

- ☒ DC:Install 4AA alkaline battery into the battery box

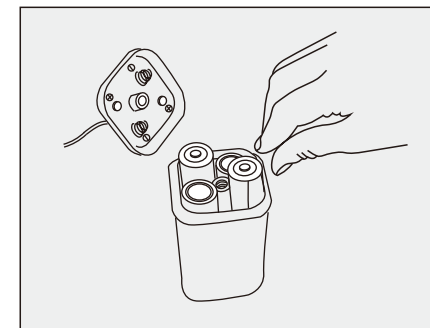
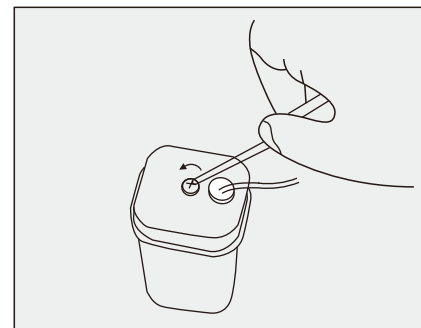

INSTALLATION STEP

Water connect

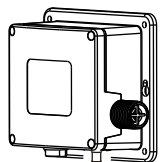

1. Water outlet hose connect
Connect the faucet body with control box by flexible hose, screw the pipe buckle tightly

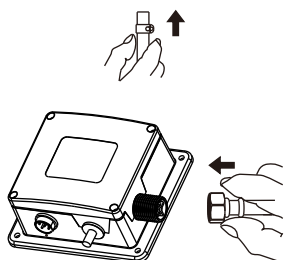

2. Water inlet hose connect
Connect 4" water supply hose with water inlet

Note:

Be sure no water leakage after connecting water

Signal line connect

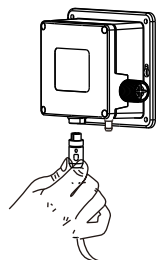

Connect signal line with control box, then screw tightly

Note:

Should keep the signal line clear and dry, be sure to work normally

PARTS NAME

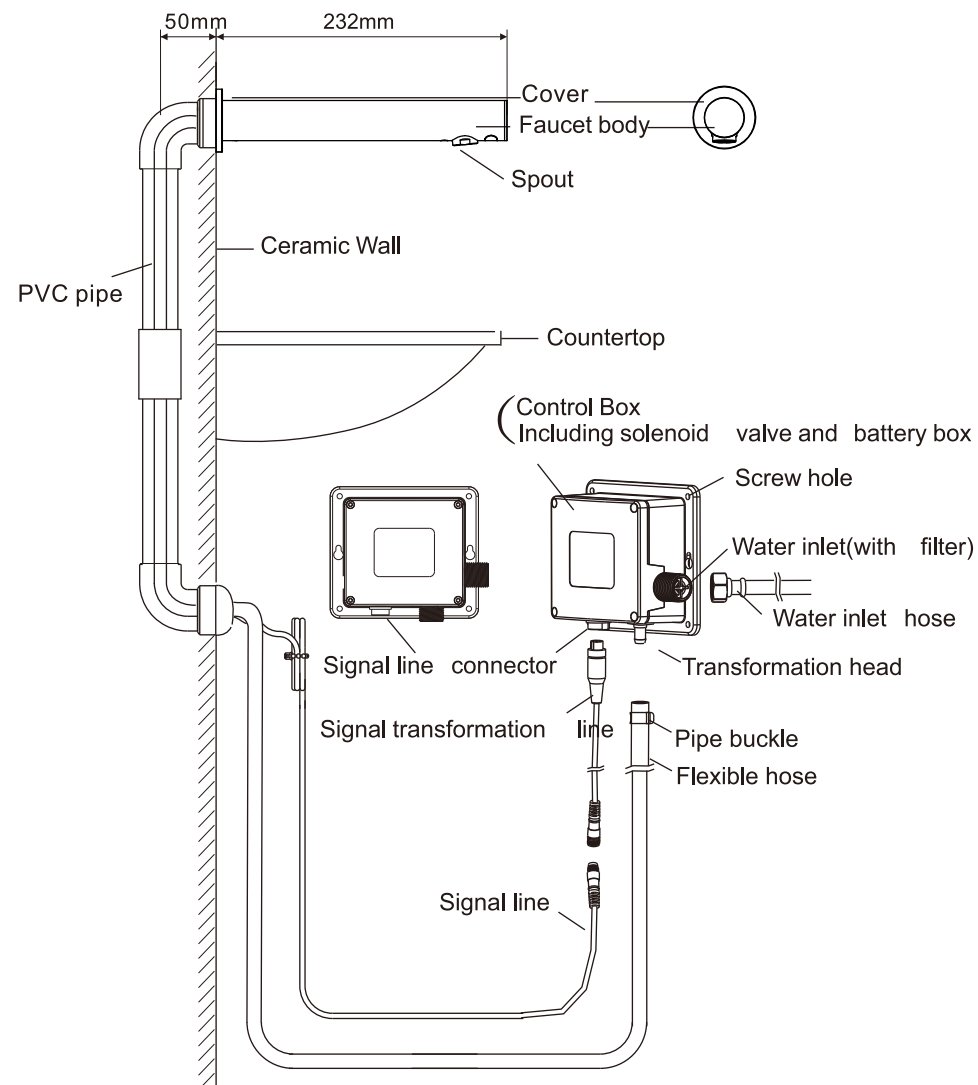

INSTALLATION STEP

Install faucet body

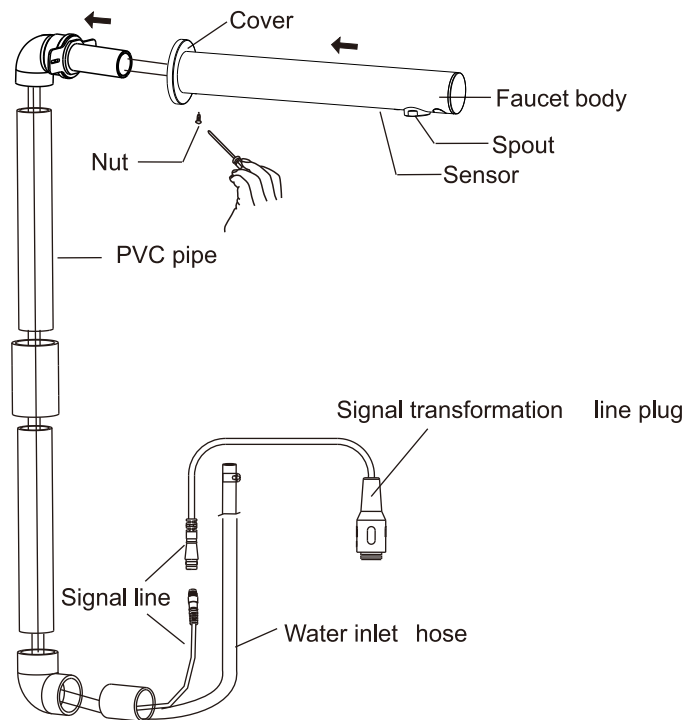

Step:

1. Insert PVC hose on wall, in order that install faucet body and signal line.
2. Put the signal line and water inlet hose inside the PVC hose.
3. Screw fixed joint and nut of faucet on tightly, then close the cover.

INSTALLATION STEP

Installation control box

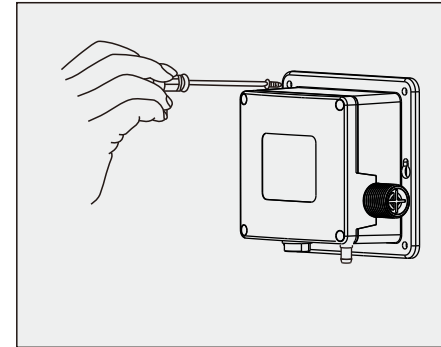

1. Put the control box on wall, drill four holes, then insert the plastic bulged tube

2. Fix the control box on wall by screw.

Note:

1. Please close the water supply and power supply before install.
 2. Be sure to install control box correct, don't put upside down.
 3. For easy to maintain, should be choose the suitable place install control box. Meanwhile, It must less than 50cm distant from the basin.
- (Please check the following picture)

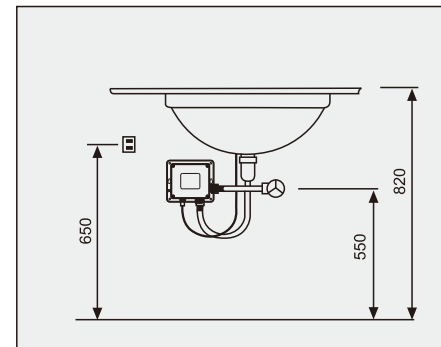

The installation drawing of control box